

The Powerhouse™ Charging Station is the perfect companion for your Eclipse™ Thermal Imager. Designed to safely house and charge the Eclipse and an accompanying battery, the Eclipse Powerhouse helps ensure that your Eclipse will always be ready for action.

## Using the Powerhouse as a free-standing unit:

### NOTE

Although the Powerhouse is designed for permanent vehicle installation, Bullard also provides an optional AC adaptor kit for unattached, free-standing use. As a free-standing unit, the Powerhouse cannot provide secure storage of the thermal imager and its spare battery in a vehicle in accordance with NFPA 1901-14.1.11.2. Free-standing use is not recommended for vehicles. The adaptor kit includes an AC power adaptor.

## Installation

The Powerhouse is designed to be mounted on any convenient flat-panel surface in a vehicle. When installed and used in accordance with these instructions, the unit is designed to comply with NFPA 1901-14.1.11.2 (see caution for proper installation).

### Location

Select a conveniently located, flat-panel surface of sufficient size to accommodate the unit. The unit can be conveniently mounted in any orientation and will comply with NFPA 1901-14.1.11.2. The unit is secured to the truck by means of two "L"-shaped aluminum brackets. The brackets attach to the truck with four (4) #10 stainless steel countersunk thread-forming Phillips-head screws, which are provided. The Powerhouse attaches to the same brackets with four (4) #10 stainless steel Phillips-head pan screws that are also provided with the unit (Figure 1).

Allow 5-inch clearance above to remove Eclipse

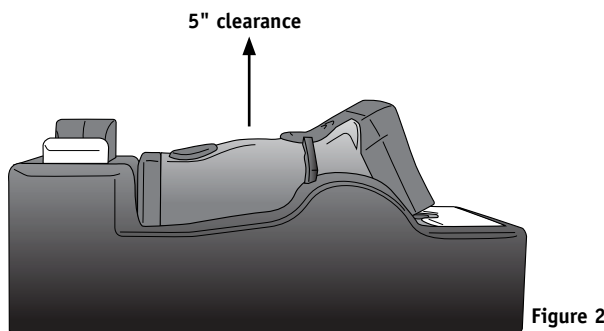

Figure 2

## Electrical Wiring

The unit is provided with a pair of wires for attachment to the power supply in the vehicle. The wires are color-coded, with red signifying the positive (+) conductor and black signifying the negative (-) conductor. Provide power to the mounting location from a 5-Ampere fused power source with a voltage of 12-24 VDC. Securely fasten the vehicle's power supply wire to the matching positive or negative wire from the Powerhouse using twist-on or crimp-style connectors. Consult an electrician if you experience difficulty or require assistance.

### NOTE

For best results, the Powerhouse should be connected to an unswitched circuit that continues to provide power when the vehicle is not in use. Wiring the Powerhouse to a switched circuit may result in discharged imager batteries if the vehicle is left idle for periods of more than a few days at a time.

## Marking and Drilling the Panel

Print Figure 3 (located on the back page of this manual) and place the template in the desired position in the truck. Mark the locations of the four countersunk holes and electrical wire hole using the template as a guide. Drill four (4) pilot holes using a #25 (0.1495"/3.75mm) drill bit from which the Powerhouse brackets will hang. Also drill a suitably sized hole (about 0.25" diameter) in the truck panel through which the Powerhouse wiring will pass, ensuring that there are no sharp edges or burrs that could harm the wiring insulation.

## Mounting the Powerhouse

Once the five holes are drilled, attach the panel-mount brackets with four (4) #10 stainless steel countersunk thread-forming Phillips-head screws that are provided (Figure 4).

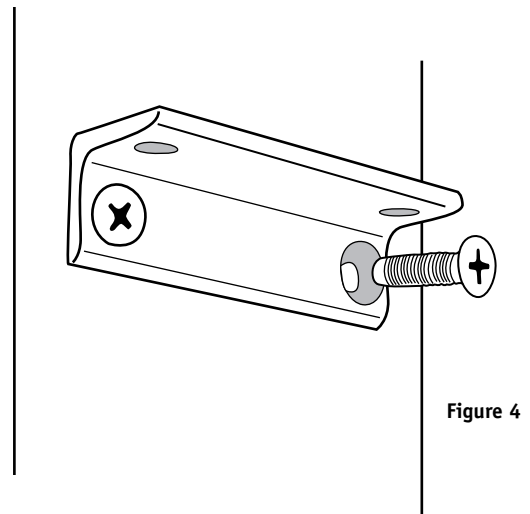

Figure 4



## Preparing the Powerhouse unit for installation

First, make sure that the power is disconnected from the supply wiring. Next, connect the positive power source wire securely to the red conductor located on the back of the Powerhouse. Then connect the negative power source wire securely to the black conductor located on the back of the Powerhouse. Lower the Powerhouse on to the mounted bracket, and attach with the four (4) #10 stainless steel Phillips-head pan screws included in your installation kit (Figure 5). You may have to press gently to compress the four rubber anti-vibration pads on the bottom of the Powerhouse in order to properly seat the screws. Installation is now complete.

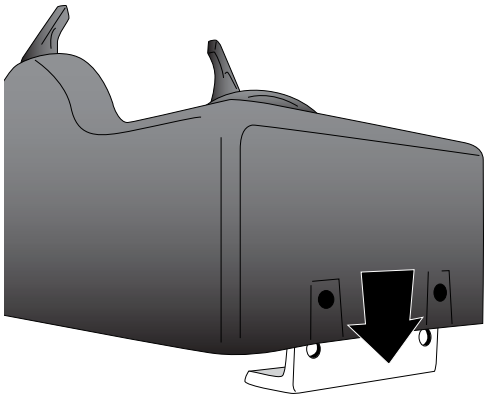

Figure 5

## Operation

The Powerhouse charging station is designed to perform the following functions:

- Securing the imager in the vehicle in accordance with NFPA 1901-14.1.11.2.
- Storing and recharging the battery in the imager and maintaining the battery at full charge.
- Securing a spare rechargeable battery in accordance with NFPA 1901-14.1.11.2.
- Storing and recharging the spare battery and maintaining it at full charge.

### Inserting the Eclipse into the Powerhouse

#### NOTE

In order to store the Eclipse in the Powerhouse, a battery must be installed in the camera. Without a battery installed, the gripper arms will not automatically secure the camera properly. Therefore, storing a camera without the battery installed can result in non-compliance with NFPA 1901-14.1.11.2, if the arms are not manually closed.

For ease of use, the Eclipse should be oriented so that viewing window is at the top and the lens is at the bottom, with the on/off switch and “Bullard” facing the user. Depress the “Bullard” button at the top of the Powerhouse to open the gripper arms. (Figure 6). Set the imager firmly into place in the Powerhouse. The gripper arms will close, and you will hear a “click” as the unit locks into place. If in a noisy environment, gently pull on the camera to ensure that the locking mechanism has engaged; otherwise, the camera will not be properly secured and could pose a hazard in a moving vehicle. As an additional indicator, the Powerhouse “Bullard” button will return to the non-depressed position once the camera has been seated properly.

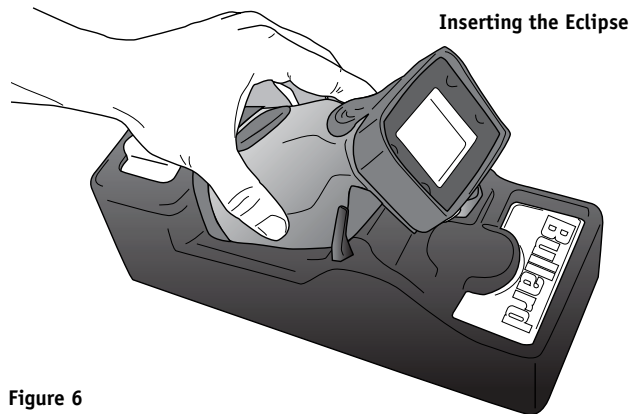
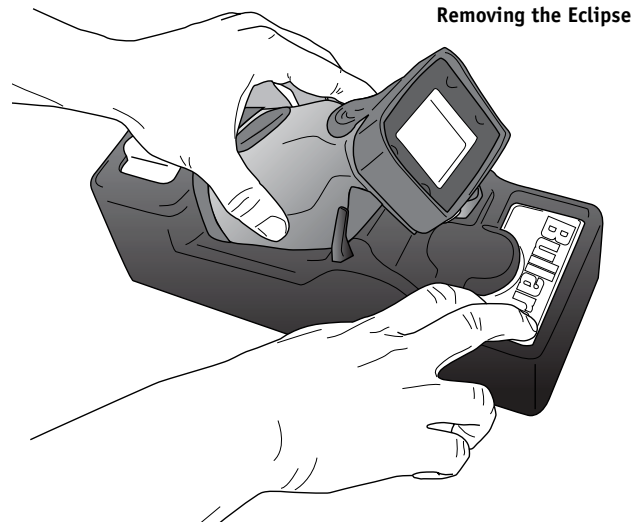

Figure 6

The battery charger is automatically activated when the imager is inserted. Battery charge condition is indicated by the color of the light emitted by the “Bullard” button. A pulsing red light indicates that the battery is being charged; a solid green light indicates that the battery is fully charged and its charge is being maintained by the Powerhouse unit.

#### NOTE

If the charging indicator light flashes between green and red for longer than 15 minutes, your battery is damaged and should be disposed of properly.

### Removing the Eclipse from the Powerhouse

Depress the “Bullard” button at the top of the Powerhouse with your thumb while grasping the imager with your hand. Once the camera has been released by the gripper arms, the imager may be pulled away from the Powerhouse unit.

# Eclipse™ Powerhouse™ Charging Station User Manual

## Inserting the spare rechargeable battery into the Powerhouse

A spare battery charging port is located at the opposite end of the charging station from the “Bullard” button. Align the battery’s molded grooves with the grooves in the charger. Slide the latch to the open position with one hand and insert the Eclipse battery into the charger with your other hand, releasing both when it locks (Figure 7). If the battery is inserted incorrectly, it will not be possible to fully insert it. In this case, the battery will not snap into place, and the charging circuit will not activate. Battery charge condition is indicated by the color emitted by the sliding latch. A pulsing red light indicates that the battery is being charged; a pulsing green light indicates that the battery is fully charged and its charge is being maintained by the Powerhouse unit.



Figure 7

### NOTE

If the charging indicator light flashes between green and red for longer than 15 minutes, your battery is damaged and should be disposed of properly.

## Removing the spare rechargeable battery from the Powerhouse

Slide the latch to the open position to release the battery. Lift the battery out of the charger while holding the latch open.

### CAUTION

The Eclipse Powerhouse is compliant with NFPA 1901-14.1.11.2 and is able to be mounted in any orientation. Please use caution when choosing a mounting location so that, if the camera is accidentally dropped while being installed in the Powerhouse, it will not injure anyone nearby. For this reason, we do not recommend mounting the Powerhouse on the ceiling of any vehicle.

Use only a fused power source of 5 amp capacity and 12-24 VDC voltage.

Ensure that the polarity of the power supply wiring is correct.

Failure to follow these instructions could result in serious injury or malfunction of the unit.

## Warranty

Bullard warrants to the original purchaser that the Powerhouse charging station is free of defects in materials and workmanship under intended use and service for a period of one year from date of manufacture. Bullard’s obligation under this warranty is limited to repairing or replacing, at Bullard’s option, articles that are returned within the warranty period and that, after examination, are shown to Bullard’s satisfaction to be defective, subject to the following limitations:

- Article must be returned to Bullard with shipping charges prepaid.
- Article must not be altered from its original configuration.
- Articles must not have been misused, abused, or damaged in transport.

In no event shall Bullard be responsible for damages, loss of use, or other indirect, incidental, consequential or special costs, expenses or damages incurred by the purchaser, notwithstanding that Bullard has been advised of the possibility of such damages.

Any implied warranties, including warranties of merchantability and fitness for a particular purpose, are limited in duration to one year from the date of manufacture of this product.

Some states do not allow the exclusion or limitation of incidental or consequential damages, or allow limitations on how long an implied warranty lasts, so the above limitations or exclusions may not apply to you. This warranty gives you specific legal rights, and you may have other rights which vary from state to state.

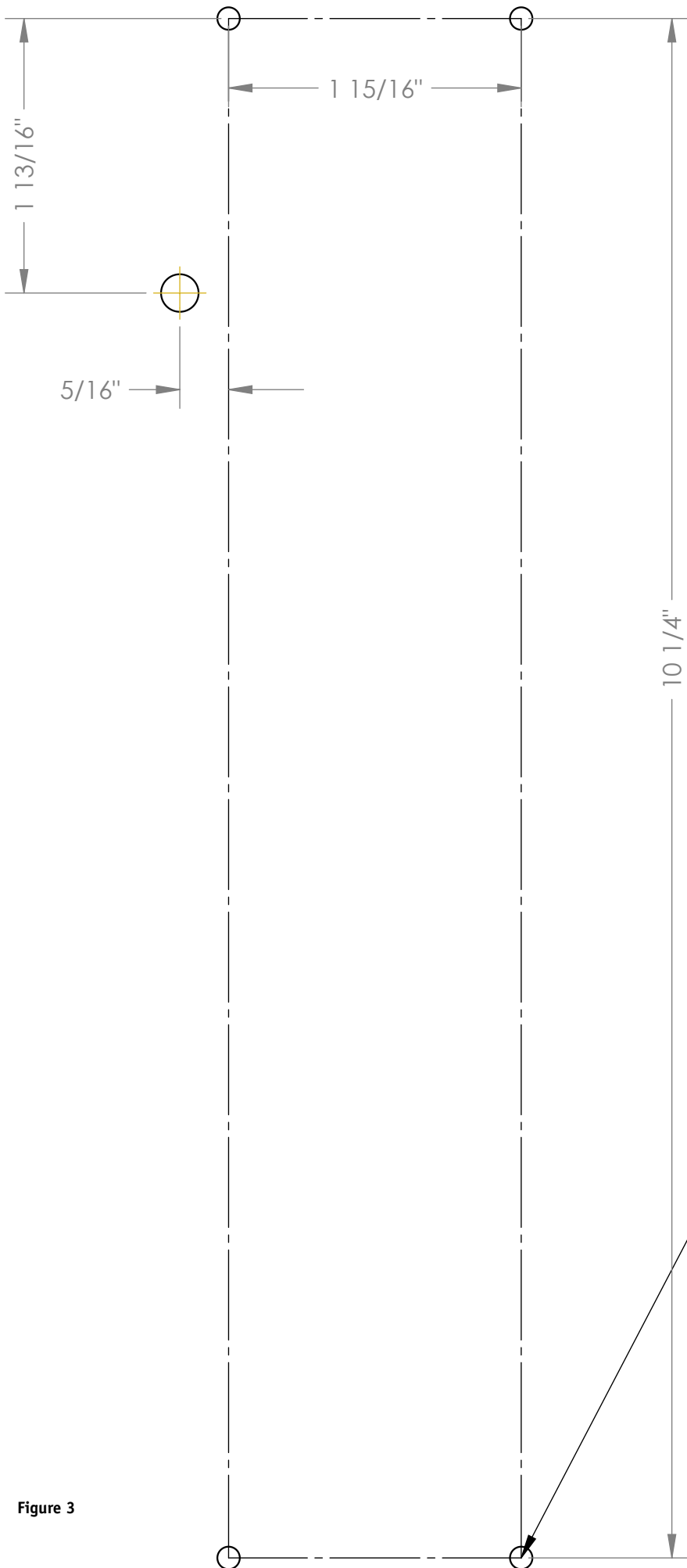

**Americas:**

**E.D. Bullard Company**  
 1898 Safety Way  
 Cynthiana, KY 41031-9303  
 Toll free: 877-BULLARD (285-5273)  
 Tel: 859-234-6616  
 Fax: 859-234-8987  
[www.bullard.com](http://www.bullard.com)

**Europe:**

**Bullard GmbH**  
 Lilienthalstrasse 12  
 53424 Remagen • Germany  
 Tel: +49-2642 999980  
 Fax : +49-2642 9999829  
[www.bullardextrem.com](http://www.bullardextrem.com)

**Asia-Pacific:**

**Bullard Asia Pacific Pte. Ltd.**  
 LHK Building  
 701, Sims Drive, #04-03  
 Singapore 387383  
 Tel: +65-6745-0556  
 Fax: +65-6745-5176  
[www.bullard.com](http://www.bullard.com)

10 1/4"

4X #25 (.1495) <sup>+0.005</sup>/<sub>-.000</sub> DRILL



©2008 Bullard. All rights reserved.  
 Eclipse and Powerhouse are trademarks of Bullard.

Figure 3